

## WD 1000T - Soldering Station Set

BestellNr.:0053402670

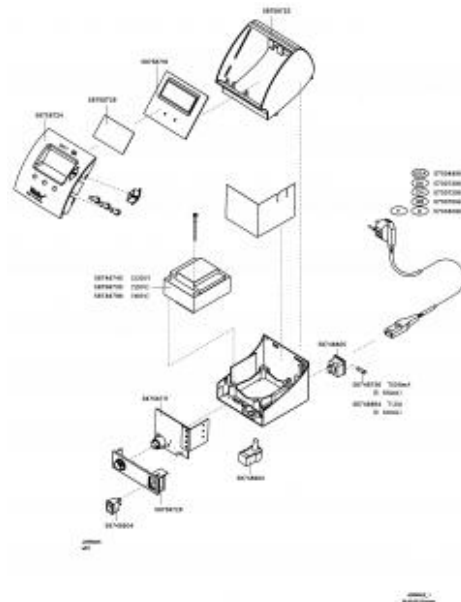

### Soldering Station Digital 160 W, 230 V, with Soldering Pencil WP 80, 80 W and Safety Rest WDH10T with Stop+Go Function

The Weller Silver Line Series has been developed for electronic experts. The tip temperature is electronically controlled. The maximum temperature is 450°C (WSD 151 550°C) within a tolerance of  $\pm 2\%$ . With the antistatic properties of the power unit and the soldering iron the stations meet all current requirements of ESD safety. Potential balance of the soldering tip can be effected by a plug. All electronically controlled Weller tools can be connected up to the maximum power of the according station. The automatic tool recognition provides the optimal settings of the tools.

#### Top Attributes

- When placing the iron in the safety rest WDH 10T the power is switched OFF at once or with time delay
- Soldering tips can be changed solely by hand, no other tool needed
- High Speed Regulation for micro soldering tools WMRP and micro tweezers WMRT
- PT Regulation for all Weller soldering tools up to 150 W
- Temperature range 50°C - 450°C
- High contrast LCDisplay
- Three shortcuts for self programmable preset temperatures
- Special function menu for custom specific calibration, SetBack, Lock, Remote ID for ISO applications
- Automatic tool recognition
- Safety class 1 (power unit), safety class 3 (soldering iron)
- Potentialfree plug (factory set hard grounded)
- Dimensions: 134 x 108 x 147 mm (L x B x H)
- Heatingup time max. 5 seconds
- USBInterface

#### Technical Data

Display technology

LC

Equipotential Bonding/ hard grounding explanation	Normal state
Temperatur control comment	Button
Display included & Size	Large
Display information content	High
ESD safe	Yes
Equipotential Bonding/ hard grounding	Yes
Display backlight	No
Antistatic housing	Yes
Temperature stability	5 °C
Power unit wattage	160 W
Mains supply Voltage	230 V
Power supply frequency	50 Hz
Output voltage	24 V
Protection class Soldering iron	3
Protection class Control/ Power unit	1
Number of tools controlled simultaneously	1
Temperature accuracy	9 °C
Temperature regulation	50 - 450 °C

## Packaging information

Shelf pack size (Units per shelf pack)	1
--	---